

Supplementary Committee Agenda



**Epping Forest
District Council**

Licensing Sub-Committee Friday, 18th December, 2020

Place: Virtual Meeting on Zoom

Time: 2.30 pm

Democratic Services: Democratic Services (Direct Line 01992 564243)
Email: democraticservices@eppingforestdc.gov.uk

8. APPLICATION FOR A PREMISES LICENCE - CAFÉ CARIBBEAN, 262 HIGH ROAD, LOUGHTON IG10 1RB (Pages 3 - 6)

Please note that the original application went to the Licensing Sub-Committee on 1 December 2020 but the meeting was adjourned (for this item) to allow the applicant to amend his application.

To consider the attached report for an amended new premises licence.

This page is intentionally left blank



Register of Licence applications received.

Date application received: 9th October 2020

Applicant name: Café Caribbean, 262 High Road Loughton IG10 1RB

The application is for a new Premises Licence for a café/restaurant serving Caribbean Food. This application went before committee on 1st December 2020, during the meeting the applicant wanted to make amendments to his application. The decision of the members was to adjourn the hearing provisionally to 18th December 2020, to allow the applicant to make the amendments. The amendments to the application have been highlighted in red:

Supply of Alcohol (on & off the premises) (Supply of alcohol on the premises only)

Monday to Thursday	11:00 to 23:00	Monday – closed,
Friday and Saturday	11:00 to 00:00	Tuesday, Wednesday, Thursday 12:00-22:00
Sunday	11:00 to 23:00	Friday, Saturday 12:00-23:00
		Sunday 12:00-22:00

Provision of Live Music

Friday and Saturday	23:00 to 00:00	(no longer requires the provision of live music)
---------------------	----------------	--

Provision of Recorded Music

Monday to Thursday	11:00 to 23:00	Monday – closed
Friday and Saturday	23:00 to 00:00	Tuesday, Wednesday, Thursday 12:00-22:00
		Friday, Saturday 12:00-23:00
		Sunday 12:00-22:00

Provision of Late Night Refreshment (no longer requires late night refreshments)

Monday to Thursday	23:00 to 23:30
Friday and Saturday	23:00 to 00:30
Sunday	23:00 to 23:30

Hours Premises will be open to the public

Monday to Thursday	11:00 to 23:30	Monday – closed,
Friday and Saturday	11:00 to 00:30	Tuesday, Wednesday, Thursday 12:00-22:00
Sunday	11:00 to 23:30	Friday, Saturday 12:00-23:00
		Sunday 12:00-22:00

Any representations regarding the above application should be made by Friday 11th December 2020 to:

Epping Forest District Council
Licensing Unit
Civic Offices
High Street
Epping CM16 4BZ

NEW REPRESENTATIONS RECEIVED

1. Judith Walker, LRA Association Plans Group (to follow in Supplementary Agenda 2).
2. Jyoti Lakhani has stated that the original representation submitted still stands (see pages 146-147 of the original agenda on 1 December 2020).

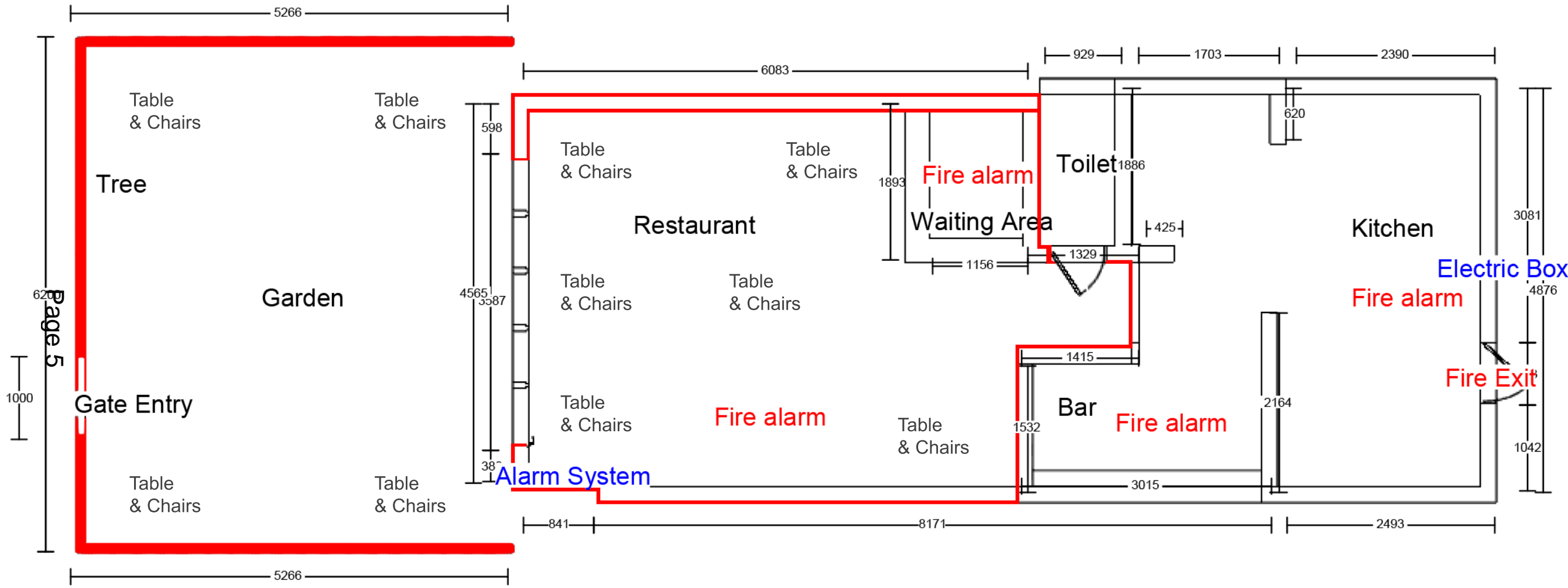

Page 5

This page is intentionally left blank